



Movexx **T1000-RVS**
PARTS & OPTIONS
2020 v2

Specifications

Technical details

Frame	Stainless steel, glass pearl blasted
Drive	24V DC, 300W, 100 rpm
Weight	40 kg (88.2 lbs)
Max. pulling force	800 N
Weight trailer	Max. 1000 kg (2204.5 lbs)
Battery	Exchangeable batterypack
Speed Max.	5 km/h (3.1 mph)
Drive wheels	Non marking full rubber Clean Room Ø 250 x 80 mm (9.8 x 3.1 in)
Adze height	831-985 mm (32.7 - 38.8 in)
Noise level	63,8 dB
To use from	-10° / 40° C (14° / 104° F)

© 2020 Movexx International B.V. The images shown are used for illustration purposes only and may differ from the products indicated. No rights can therefore be derived from it. Printing errors are subjected to change. The datasheet is the confidential product of Movexx International B.V. and no portion of this datasheet may be copied, performed, or redistributed without the express written authority of Movexx International B.V.

Pulling power (in kg)

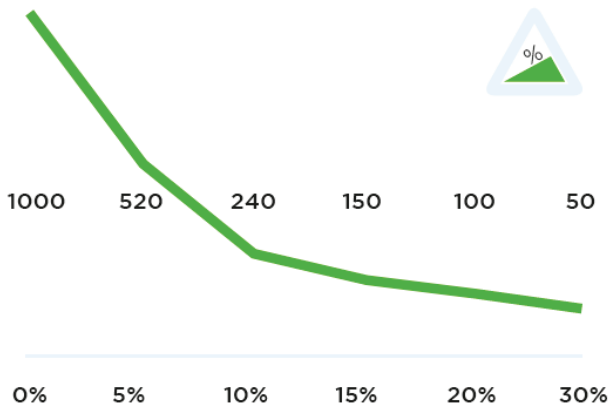

Measured with a trolley with 2 swivel wheels and 2 fixed castors. Wheel Ø 160 mm.

Dimensions

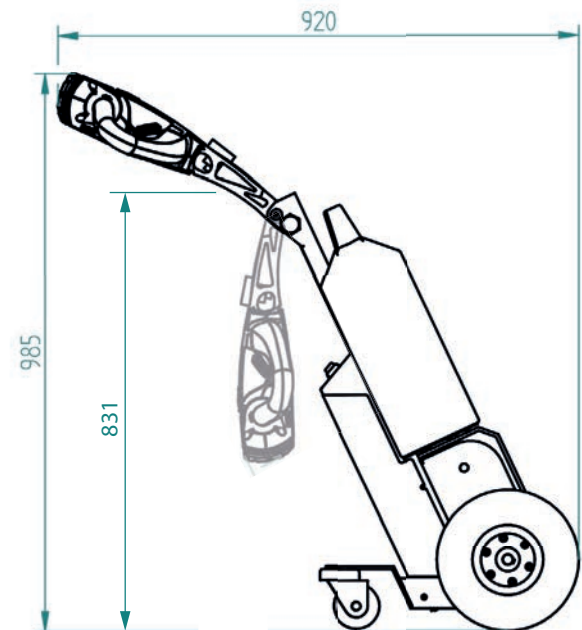
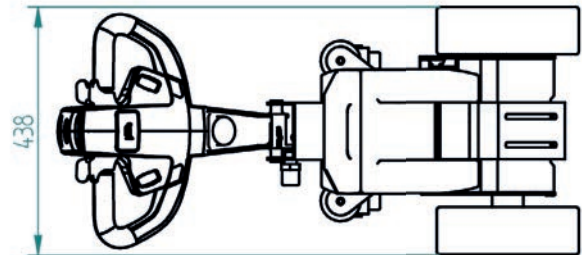

Standard parts

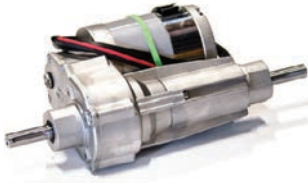

Motor 300W / 100rpm
(6911345X) without brake
Item number M1032



LED battery indicator
Item number M0123



Charger (external)
AGM battery 24V / 5A
Item number OPT0009



Battery AGM-VRLA green
24V / 22Ah
Item number OPT0110



Drive wheel, Cleanroom
full rubber, non-marking
Gray Ø 250 x 80 mm
Item number M0249



Adjustable tiller head
Item no M6021-0500

Standard parts



Belly button RED
Item number M0121-BBUT



2 programmable speeds

Options



Extra plug to recharge
the battery
*for on-machine battery
charging*
Item number OPT0001



UPGRADE:
(only with new machines)
Drive wheel full rubber,
non-marking
Grey 2x Ø 250 x 80 mm
Item number OPT0359



UPGRADE:
(only with new machines)
Drive wheel foam filled,
non-marking
Grey 2x Ø 250 x 80 mm
Item number OPT0361

Options



Horn 90dB for stainless steel tiller head supp.
Item number OPT0414



Horn 103dB
Item number OPT0059



Emergency stop complete
Item number OPT0063



Strobe light for stainless steel tiller head supp.
Item number OPT0415



Audio signal (while driving)
Item number OPT0253

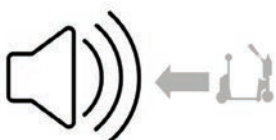

Audio signal (driving backward)
Item number OPT0254

Options



Remote set 4 channel, 2,4 GHz
Item number OPT0505



Electromagnetic parking brake
Item number OPT0004



Counterweight (front) 30kg, stainless steel
Item number OPT0035



Hour tracker
Item number OPT0056



Antistatic strip
Item number OPT0058



Code lock
Item number OPT0068

Options



Document holder for stainless steel tiller head supp.

Item number OPT0053



Storage system (incl. snap hooks) for steel tiller head supp. M1002-0100

Item number OPT0482



Preparation electric hook

Item number OPT0143

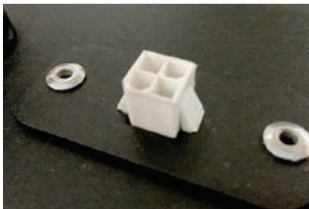

Diagnostic connector

Item number OPT0270



Ignition key (unequal)

Item number OPT0145



Ignition key 701 (equal)

Item number OPT0146

Options



On/off rotary switch

Item number OPT0016



Parking floorlabel Ø 60 cm

Item number OPT0245



Customized programming
Please indicate specific settings

Item number OPT0170



Programmer for Italsea

Item number D0003



Urgent order purchase

Item number SPOED

Batteries and Chargers



Battery AGM-VRLA green
24V / 22Ah
Item number OPT0110



Charger (external)
AGM battery 24V / 5A
Item number OPT0009



Battery Lithium green
(LiFePO4) 25,6V / 36Ah
Item number OPT0106



Charger (external)
Lithium battery 25,6V / 10A
Item number OPT0013



UPGRADE:
(only with new machines)
Battery Lithium (LiFePO4)
+ charger
Item number OPT0107



Wall mounted AGM
charger, incl. AGM
charger 24V / 5A
Item number OPT0015

Batteries and Chargers



Wall mounted AGM
charger, incl. AGM
charger 24V / 5A
stainless steel
Item no OPT0015-RVS



Wall mounted Lithium
charger, incl. Lithium
charger 25,6V / 10A
Item number OPT0023



Wall mounted Lithium
charger, incl. Lithium
charger 25,6V / 10A
stainless steel
Item no OPT0023-RVS



Charging station Lithium
(5x), incl. Lithium
charger 25,6V / 10A
Item number OPT0029



Charging station AGM
(5x), incl. AGM
charger 24V / 5A
Item number OPT0039



Charging station AGM
(5x), incl. AGM
charger 24V / 5A
stainless steel
Item no OPT0039-RVS

Batteries and Chargers



UPGRADE:
(only with new machines)
Wall mounting for charger
(for AGM or Lithium)
Item number OPT0261

Adapters



Electric locking module
for hook
Item number OPT0129

Adapters



Base part hook 15°
Stainless steel
Item number H7011



Clamping hook
(stainless steel)
Item number H0096



Clamping hook (HD)
(range: 0 - 100mm)
Item number H0152



Angle limitation hook 15°
Item number OPT0218



Clamping hook (HD), Inox
(range: 0-100 mm)
Item number H0152-INOX

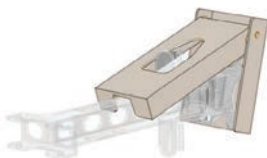

Hook locking system
stainless steel
Item number OPT0012



HA245.55.45.0.0
(stainless steel)
**Item number H0004 CR
+ OPT0202**



Electric lifting module
for hook, stainless steel
Item no OPT0050-RVS



Vacuum hook
for stainless steel trolley
Item number H0093

Most common spareparts



Battery AGM-VRLA green
24V / 22Ah
Item number OPT0110



Charger (external)
AGM battery 24V / 5A
Item number OPT0009



Battery Lithium green
(LiFePO4) 25,6V / 36Ah
Item number OPT0106



Charger (external)
Lithium battery 25,6V / 10A
Item number OPT0013



Battery guide
(stainless steel)
Item number M0482



Battery connector SB50
Item number M0105

Most common spareparts



Belly button RED
Item number M0121-BBUT



Switch buttons (2x) green
Item number M0121-KNOP-GROEN



Switch tiller head
excl. buttons
Item number M0121-FLIPPER



Feather/shaft Throttle
Item number M0121-4



Switch FAST/SLOW
tiller head green
Item number M0121-SPEED-GROEN



Switch ON/OFF
tiller head green
Item number M0121-AANUIT-GROEN

Most common spareparts



Plain sleeve bearing
Ø8 / 12 x 6, 16 x 2 mm
Item number M4038



Locking pin
M16 x 1,5 mm
Item number M0001



Torsion spring for hook
(stainless steel)
Item number M0117-SP



Clamping hook (HD)
(range: 0 - 100mm)
Item number H0152-SP



Italsea drive controller
in 24V / 36 bat,
in 10A / I_{max} 45A
Item number M1122-SP



Carbon brushes (set of 4)
for Motor 300W
Item number M0186

Most common spareparts



LED battery indicator
Item number M0123



Cable harness complete
Item number M1127-M050



Fuse 5A
Item number M0506



Fuse Maxi 40A
Item number M0254



Drive wheel, Cleanroom
full rubber, non-marking
Gray Ø 250 x 80 mm
Item number M0249



Drive wheel
full rubber, non-marking
Gray Ø 250 x 80 mm
Item number M0115

Most common spareparts



Drive wheel, foamed at
2b, gray Ø 250 x 80 mm
Item number M0092



Castor wheel
Gray Ø 80 mm
Item number M0119

applications



moveXX
driven by brain power

Generatorstraat 17-19
3903 LH Veenendaal
The Netherlands

T +31 (0)318 519900
E info@movexx.com
W www.movexx.com

